



**GECKO DEPOT**

[www.geckodepot.com/europe](http://www.geckodepot.com/europe)

Spa packs, keypads, pumps,  
accessories, parts & more!  
For spa distributors, dealers,  
techs and trade professionals!

*Aeware*  
by GECKO

**aqua-flo**  
by GECKO

**CLASS**  
Clearly Advanced Spa Systems™

  
**GECKO**®

# 2015

EUROPE EDITION  
PRODUCTS & PARTS CATALOGUE





**Spa Controls**

Y Series systems ..... 4  
 X Series systems ..... 6  
 CLASS systems ..... 8

**Boards**

Y Series ..... 5  
 MSPA ..... 9

**Spa Keypads**

Aeware keypads and overlays ..... 10  
 M-CLASS keypads and overlays ..... 12  
 S-CLASS keypads and overlays ..... 13

**Wi-Fi Spa Module**

in.touch ..... 14

**Spa Cables**

Aeware in.link cables ..... 15  
 AMP cables & adaptors ..... 15

**Spa Sanitizers**

in.clear bromine generator ..... 16  
 Chemical products ..... 16

**Aqua-flo Pumps for Spas**

Flo-Master XP2e ..... 18  
 Circ-Master HP & CP ..... 20

**Waterproof Audio**

in.stream ..... 22

**Low Level Configuration**

in.yt ..... 23  
 in.ye ..... 24  
 in.xm ..... 25  
 in.xe ..... 26

**Our company**

Gecko Depot’s mission is to offer the best technical service in the industry and to provide replacement parts in the aftermarket. Once we’ve determine what is to be replaced, we make sure to connect you to one of our local accredited stockists.

**Our products**

Our electronic spa controls combine innovation and versatility, and work with a wide range of spas, from the simplest to the most complex. Easy to install, with configuration menus accessible from the keyboard – our replacement kits are great value, and are sure to be a must-have in the repair truck.

We also manufacture Aqua-flo pumps, known for their energy efficiency and their superior hydraulic capacity. Whether you want to reduce your energy consumption without losing out on power, or to gain power without paying a bundle in energy bills, we have a pump for you.



Aeware®, Gecko®, and their respective logos are Registered Trademarks of Gecko Alliance Group. All products listed in the catalogue, and their respective logos, are Trademarks of Gecko Alliance Group. All other product or company names that may be mentioned in this publication are tradenames, trademarks or registered trademarks of their respective owners.

# Aeware Spa Controls Y Series



**Y Series**  
whatever the spa, this is your control system

See  
Low Level  
Configuration  
at page 23-24.

in.yt-7  
W x H x D: 497 x 368 x 130 mm (19.58" x 14.5" x 5.16")  
Weight: 5.5 kg (12 lb)

in.ye-5  
W x H x D: 497 x 273 x 126 mm (19.58" x 10.75" x 4.98")  
Weight: 4.4 kg (9.7 lb)

in.yj-2  
W x H x D: 307 x 187 x 95 mm (11.83" x 7.38" x 3.74")  
Weight: 3.5 kg (7.7 lb) with heater

- Each pack supports keypads, heater, a 12 V AC light, and configurable relays (2, 5 or 7, depending on model)
- Solid-state water flow detection: No pressure switch to adjust
- IPX5 rated waterproof design
- Preloaded configuration allows fast and easy installation
- in.touch Wi-Fi module compatible
- Connector: AMP, Quick Connect, JJM adaptor available
- Supports 1, 2 and 3 phase input power (in.yj is single phase only)
- Standard 3 kW, 2" x 15" flow thru heater (minimum of 75 L/min required)
- Aeware keypad compatible
- Temperature probe is built into the heater
- Free and overheat protections
- Self-Diagnostic
- Programmable filter cycles
- Corrosion-free enclosure



in.touch  
ready!

## Y Series Product Selector: number of configurable outputs defines supported optional accessories

Features	in.yj-2 (2 outputs)	in.ye-5 (5 outputs)	in.yt-7 (7 outputs)	
Model & PN	<b>BDLYJK300CE</b>	<b>0610-221017</b>	<b>0611-221009</b>	
Receptacle type	Quick Connect only	AMP or Quick Connect	AMP or Quick Connect	
Optional Accessories	Pump 1	Up to 2 out of the list. Dual speed pumps use 2 outputs	Up to 5 out of the list. Dual speed pumps use 2 outputs	
	Pump 2			
	Pump 3	Up to 7 out of the list. Dual speed pumps use 2 outputs		
	Pump 4			
	Pump 5	Example using 2 outputs: <b>P1-2spd, Ozone tied to low speed</b>	Example using 5 outputs: <b>P1-2spd, P2-1spd, Blower and Ozone</b>	Example using 7 outputs: <b>P1 dual speed, P2 dual speed, P3-1spd, Blower and Ozone</b>
	Blower			
	CP			
	Ozone			
Included	Direct outlet	•	•	
	Light (12 W @ 12 V)	•	•	
	Heater (75 L/min minimum water flow required)	3 kW Other available ratings: 1.3kW, 2kW and 4kW	3 kW Other available ratings: 1.3kW, 2kW and 4kW	4 kW Other available ratings: 1.3kW, 2kW and 4kW
Topside control	in.k100 auxiliary panel	•	•	
	in.k120 auxiliary panel	•	•	
	in.k200	•	•	
	in.k300	•	•	
	in.k19 - 35 - 45	•	•	
	in.k450	•	•	
	in.k600 ST 5 OP	•	•	
	in.k600 Graphic	•	•	
	in.k500 - 800	•	•	
	in.touch Wi-Fi	•	•	



**Y Series exploded view**

Fuses, Y Series:  
 F4 transformer 0.250 A (in.ye & in.yt only)  
**430AC0285**  
 F1, F2 & F3 Pump, Acc. 20 A  
**430AC0069**

in.yt expansion boards  
 in.yt-7-2 outputs  
**9920-201093**

Y Series packs:  
 in.ye-5: **0610-221017**  
 in.yt-7: **0611-221009**

Transformer (in.ye & in.yt only):  
**560AA0457**

Y Series main boards  
 in.ye-5: **9920-201121A**  
 in.yt-7: **9920-201122B**



Light cable & socket  
**9920-400489** (2.44 m or 8')

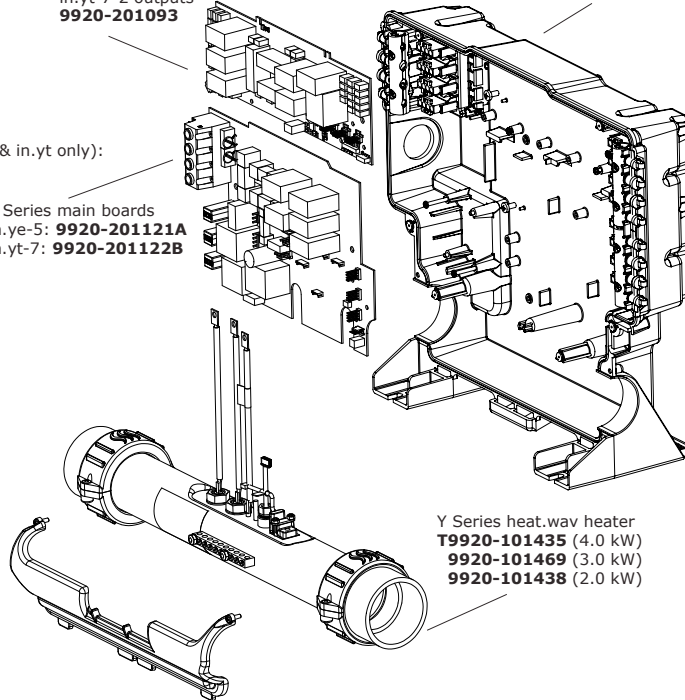
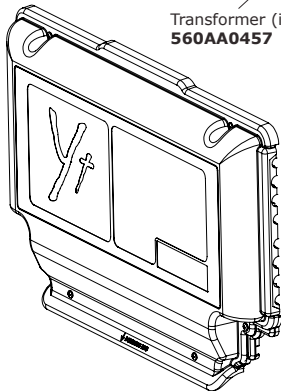

Y Series heat.wav heater  
**T9920-101435** (4.0 kW)  
**9920-101469** (3.0 kW)  
**9920-101438** (2.0 kW)

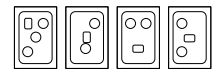

AMP to JIM Receptacle  
**9920-101477** (kit of 4)

**in.yj exploded view**

Fuses in.yj:  
 F2, pump & Acc. 32 A  
**430AE0096**

Z bracket in.yj  
**9917-106758**

Bracket in.yj  
**9917-102121**

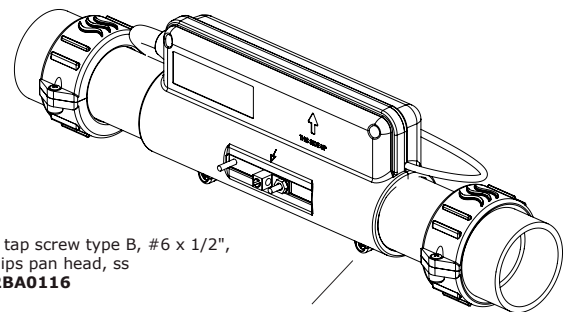

Self tap screw type B, #6 x 1/2",  
 Phillips pan head, ss  
**282BA0116**

in.yj heat.wav heater  
**0613-421001** (4 kW)  
**0613-421002** (3 kW)  
**0613-421003** (2 kW)  
**0613-421004** (1.3 kW)

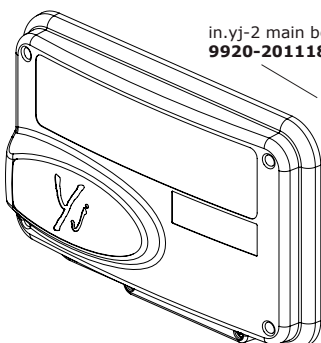

in.yj-2 main board  
**9920-201118A**

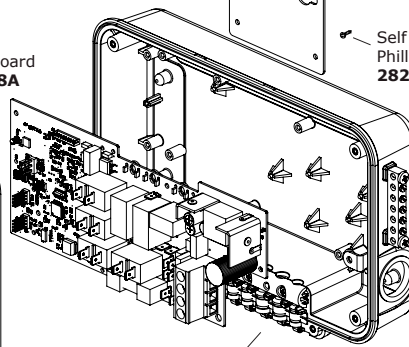

in.yj-2-CE-GD1 pack  
**0612-221008**



Light cable & socket  
**9920-400489** (2.44 m or 8')



# Aeware Spa Controls X Series



**X Series**  
rugged spa pack platform for high-end spas

See  
Low Level  
Configuration  
at page 25-26.

in.xe  
W x H x D: 490 x 298 x 136 mm (19.58" x 11.75" x 5.1")  
Weight: 4.76 kg (10.5 lb)

in.xm2  
W x H x D: 451 x 253 x 101 mm (17.8" x 10" x 4")  
Weight: 3.4 kg (7.6 lb)

- IPX5 waterproof rated
- Versatile pack that can support up to:  
in.xm2: 5 pumps, blower, circ pump, ozone & stereo outlet  
in.xe: 2 pumps, blower, Ozone or circ pump & stereo outlet
- Preloaded configurations allow fast and easy installation
- Large terminal block for easier electrical installation
- Supports 1, 2 and 3 phase input power (in.xe is 1 or 2 phase only)
- Standard 3 kW, 2" x 15" flow thru heater (minimum of 75 L/min required)
- Programmable filter cycles
- Self-diagnostic
- Solid state dry-fire protection
- Kinetic heat, overheat & anti-freeze protections
- Supports high-end & auxiliary topsides



in.touch  
ready!

## X Series Product Selector

Features		in.xe	in.xm2
Order info	Model & PN	<b>0602-221047</b>	<b>0601-221105</b>
	Receptacle type	in.link	in.link
Pumps	Pump 1	1 or 2 spd	1 or 2* spd
	Pump 2	1 spd	1 or 2* spd
	Pump 3		1 spd
	Pump 4		1 spd
	Pump 5		1 spd
Accessories	Blower	2 accessories out of them: Blower & Ozone or Blower & CP or CP & Ozone	•
	CP		•
	Ozone		•
	Direct outlet	•	•
	Light (12 W @ 12 V AC)	•	•
Heater (75 L/min water flow required)		3.0 kW	Sold separately: <b>0603-421001</b> in.therm 3.8 kW <b>0603-421003</b> in.therm 2.0 kW
Topside control	in.k100 auxiliary panel		•
	in.k120 auxiliary panel	•	•
	in.k200	•	
	in.k300		•
	in.k19 - 35	•	
	in.k450 - 45	•	•
	in.k600 ST 5 OP	•	•
	in.k600 Graphic		•
	in.k500 - 800		•
in.touch	•	•	

\* Allowed Current Draw is 7 AMP per pump on 4 & 5 pump systems. Pump 1 and 2 low speed relays can be used to control 5 single speed pump systems. The in.xm2 replaces the in.xm, and retains compatibility.



### in.xm exploded view

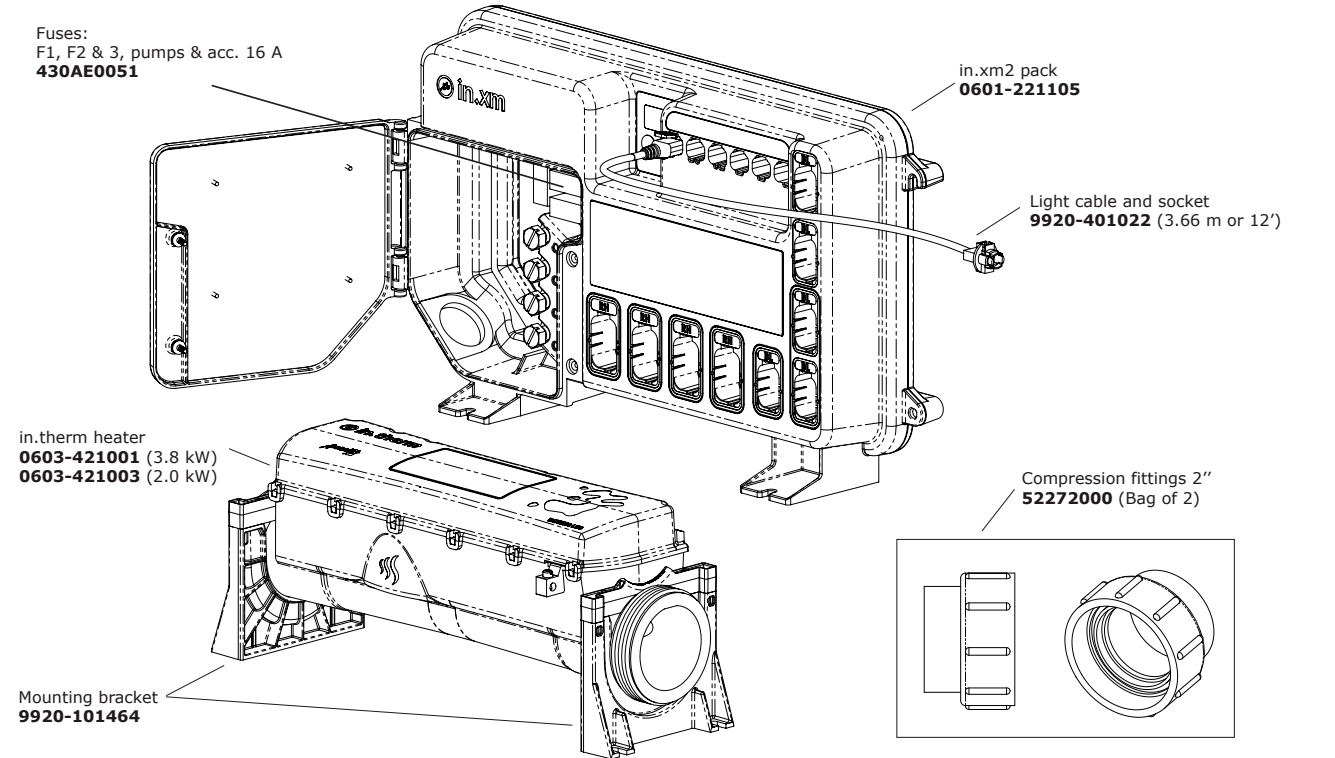

### in.xe exploded view

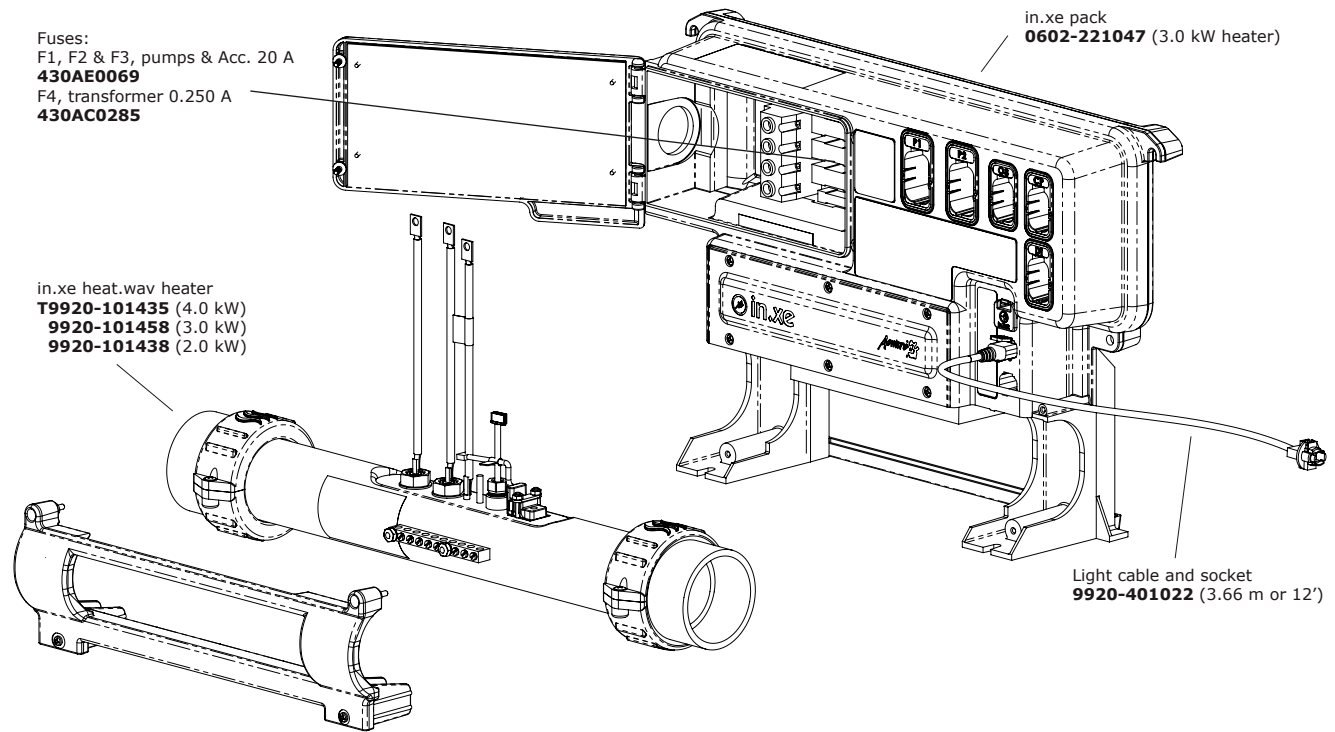

# CLASS Spa Controls

## S-CLASS & M-CLASS



S-CLASS  
W x H x D: 362 x 292 x 86 mm (14.25" x 11.5" x 3.38")  
Weight: 5 kg (11 lb)

- Water Overheat and Smart Winter Freeze protection
- 2" x 15", 2.0 kW electric heater
- Pressure switch based dry-fire protection
- Programmable filter cycles
- Self-diagnostic
- JJM receptacles

### M-CLASS

- Supports up to 5 pumps, blower, ozone and optional circ pump
- Board replacement available
- Supports Auxiliary topside TSC-3
- 1, 2 or 3 phase compatible

### S-CLASS

- Supports up to 2 pumps, blower, ozone and optional circ pump
- Single Phase compatible only

### CLASS Series Product Selector

Features		S-CLASS		M-CLASS
Order info	Model & PN (receptacle type)	<b>0202-201023</b> (JJM)	<b>0202-201024</b> (JJM)	Replacement board only see <b>0201-300046</b>
	Pumps	Pump 1 2 spd Pump 2 1 spd*	Pump 1 2 spd Pump 2 1 spd*	Pump 1 1 or 2 spd* Pump 2 1 or 2 spd* Pump 3 1 spd*
Accessories	Blower		•	multi-speed*
	CP	•*	•*	•*
	Ozone	•	•	•
	Direct outlet	•	•	•
	Light (12 W @ 12 V AC)	•	•	•*
	Heater	2.0 kW	2.0 kW	3.6 kW
Topside control	TSC-9	•	•	
	TSC-18	•	•	
	TSC-19	•	•	
	TSC-35	•	•	
	TSC-8 (8 or 10keys)			•***
	TSC-4 (8 or 10keys)			•***
Jumper configuration	JMP 1	Current Mode <b>High / Low</b>	Circ. Pump <b>not installed / installed</b>	Current Mode <b>1Phase, 1 x 32 A / 3 Phase, 3 x 16 A</b>
	JMP 2	Keypad type <b>4 btns / 6 btns (TSC-35)</b>	Pump 2 <b>installed / not installed</b>	Keypad: nbr of keys <b>10 btns / 8 btns</b>
	JMP 3	Circ. Pump <b>not installed / installed</b>	Keypad type <b>4 btns / 6 btns (TSC-35)</b>	Keypad type TSC-4 (icons in screen)/ <b>TSC-8</b>
	JMP 4**	Pump 2 or Blower <b>not installed / installed</b>	n/a	Keypad orientation TSC-47 (reverse)/ <b>TSC-8 (Standard)</b>

\* Optional:

S-CLASS: Can be configured using on-board jumpers. Blower can be installed instead of Pump 2.

M-CLASS: 20 sec. long press on Economy or ON/OFF key will put the system in programming mode.

\*\* S-CLASS Jumper: jumper 4 is located in the connector P26 of the S-CLASS board.

\*\*\* 10 keys topside is mandatory to control 3 pump systems.



### S-CLASS exploded view

Fuses:

- F4, Transformer 0.5 A  
**430AD0036**
- F3, Light, 2.0 A  
**430AD0084**
- F1, F2 & F5, Line 1 & 2, Heater 25 A  
**430AE0033**

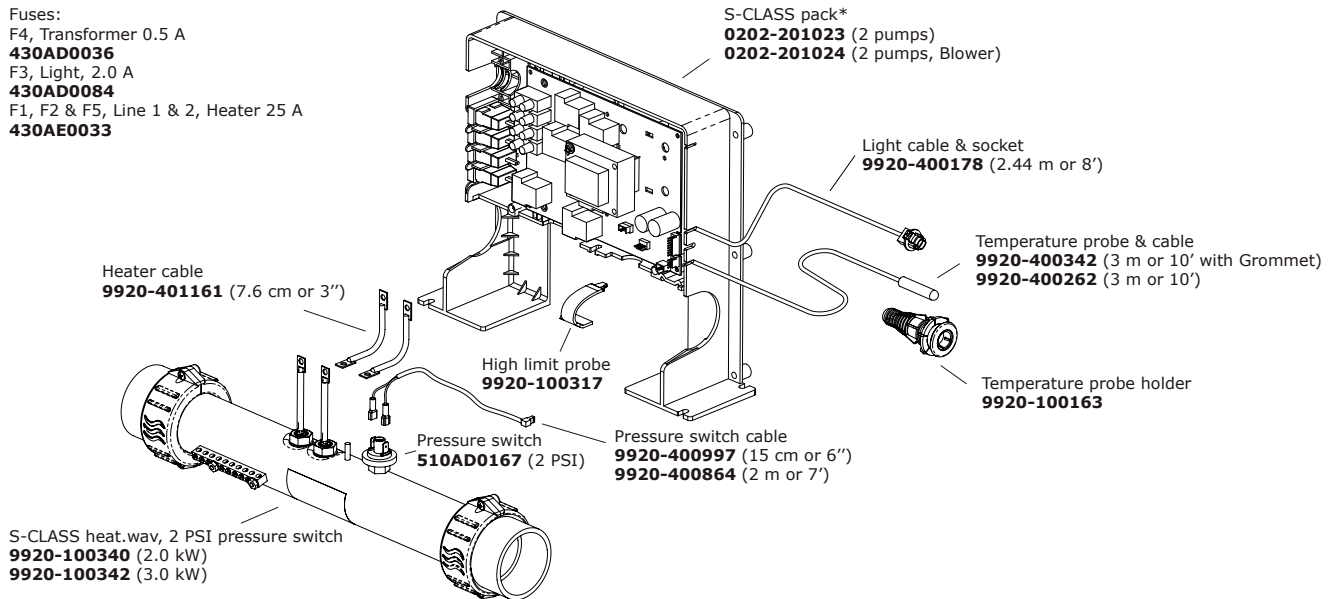

### M-CLASS exploded view

Fuses, MSPA-MP:

- F9, transformer 0.630 A  
**430AD0103**
- F1, Light, 2.0 A  
**430AD0084**
- F2, F5 & F8, Pumps 1, 20.0 A  
**430AE0027**
- F4, Blower 6.3 A  
**430AD0043**
- F3, F6, CP, O3 & Accessory 5.0 A  
**430AD0024**

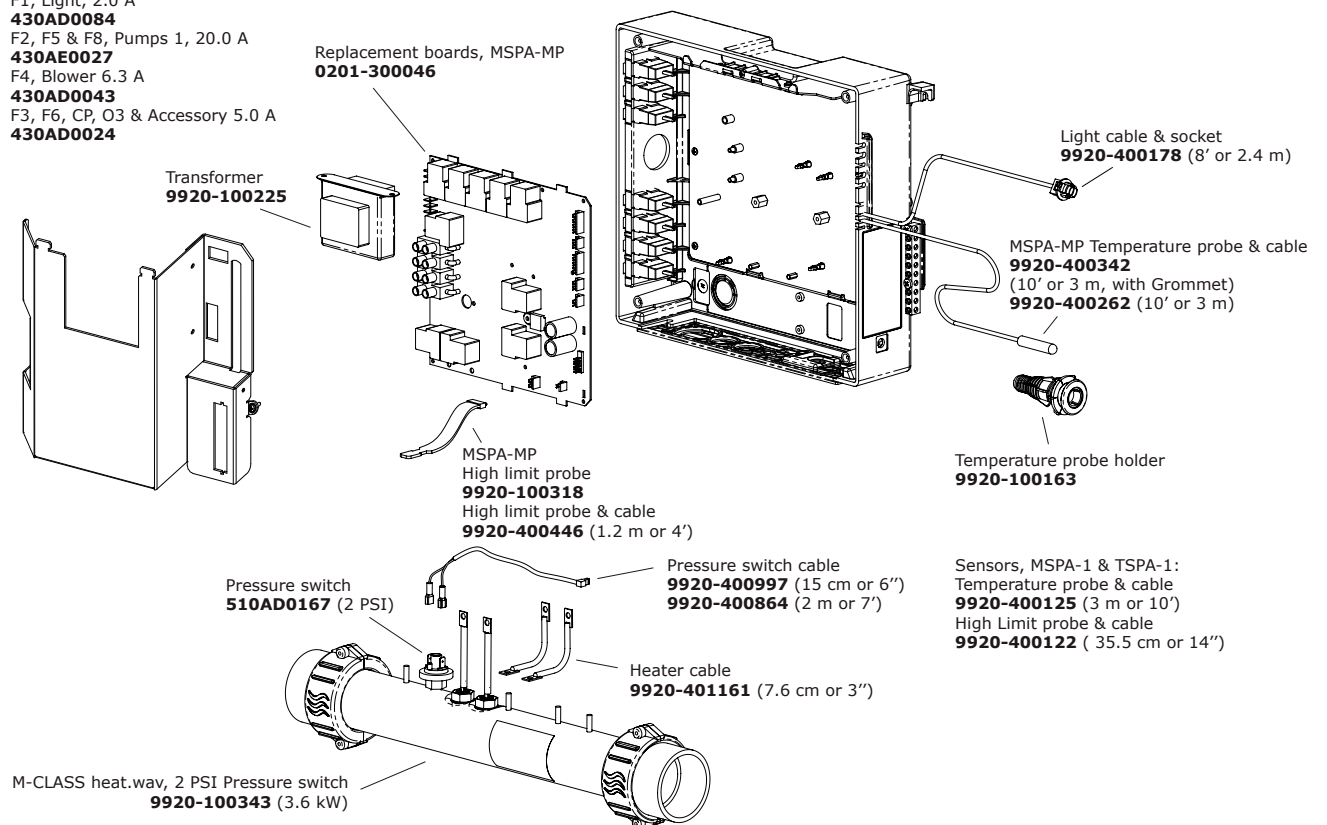



## Spa Key pads

### Aeware keypads



Code **0607-008030**

#### IN.K800-CLEAR AND OVERLAY GE1

Includes: in.k800 Color keypad and overlay (9916-101480)  
 10 buttons: Settings/Mode/P1/P2/P3/AUX1/AUX2/Light/Up/Down  
 Dimensions: 22.2 x 10.8 cm (8-3/4" x 4-1/4")  
 Cord length: 3 m (10')  
 Compatible with: Y Series systems  
 Installation: MUST be installed on the OUTSIDE edge of the hot tub



Code **0607-008033**

#### IN.K500-CLEAR AND OVERLAY GE1

Includes: in.k500 Color keypad and overlay (9916-101495)  
 7 buttons: Settings/Light/Mode/Pump 1/Pump 2/Up/Down  
 Dimensions: 18.2 x 8.46 cm (7.16" x 3.33")  
 Cord length: 3 m (10')  
 Compatible with: Y Series systems  
 Installation: MUST be installed on the OUTSIDE edge of the hot tub.



Code **BDLK6005OP**

#### IN.K600-5OP AND OVERLAY

Includes: in.k600 keypad with streamlined interface (0607-009014), overlay (9916-101382)  
 11 buttons: Light/Pump 1 to 5/OK/+/-/Prog/Power  
 Dimensions: 22.2 x 10.8 cm (8-3/4" x 4-1/4")  
 Cord length: 3 m (10')  
 Compatible with: in.xe, in.xm, in.xm2 & Y Series systems



Code **BDLK600GF**

#### IN.K600-GF AND OVERLAY

Includes: in.k600 keypad with menu-driven interface (0607-007014), overlay (9916-101381)  
 11 buttons: Functions 1 to 4/Left/Right/OK/+/-/Mode/Next  
 Dimensions: 22.2 x 10.8 cm (8-3/4" x 4-1/4")  
 Cord length: 3 m (10')  
 Compatible with: in.xm, in.xm2 systems



Code **BDLK4503OP**

#### IN.K450-3OP AND OVERLAY

Includes: in.k450 keypad (0607-005008), overlay (9916-101335)  
 7 buttons: On/Pump 1/Pump 2/Pump 3/Light/Up/Down  
 Dimensions: 18.1 x 7.6 cm (7-1/4" x 3")  
 Cord length: 3 m (10')  
 Compatible with: in.xe, in.xm, in.xm2, Y Series systems



Code **BDLK353OP**

**IN.K35-3OP AND OVERLAY**

Includes: in.k35 keypad (**0607-007028**), overlay (**9916-101206**)  
6 buttons: Pump 1/Pump 2/Blower/Light/Up/Down  
Dimensions: 17.8 x 8.25 cm (7" x 3-1/4")  
Cord length: 3 m (10')  
Compatible with: in.xe & Y Series systems



Code **BDLK3001OP** (1 pump) **BDLK3002OP** (2 pumps)

**IN.K300 AND OVERLAY**

Includes: in.k300-1OP keypad (**0607-008036**), overlay (**9916-101499**)  
4 buttons: Pump 1/Light/Up/Down  
or  
Includes: in.k300-2OP keypad (**0607-008037**), overlay (**9916-101500**)  
4 buttons: Pump 1/Pump 2/Light/Up-Down  
Dimensions: 15.9 x 7.5 cm (6-1/4" x 2-1/4")  
Cord length: 3 m (10')  
Compatible with: Y Series systems



Code **BDLK191OP** (1 pump) **BDLK192OP** (2 pumps)

**IN.K19 AND OVERLAY**

Includes: in.k19-1OP keypad (**0607-007026**), overlay (**9916-101205**)  
4 buttons: Pump 1/Light/Up/Down  
or  
Includes: in.k19-2OP keypad (**0607-007027**), overlay (**9916-101204**)  
4 buttons: Pump 1/Pump 2/Light/Up,Down  
Dimensions: 17.8 x 8.25 cm (7" x 3-1/4")  
Cord length: 3 m (10')  
Compatible with: in.xe & Y Series systems



Code **BDLK2001OP** (1 pump) **BDLK2002OP** (2 pumps)

**IN.K200 AND OVERLAY**

Includes: in.k200-1OP keypad (**0607-008004**), overlay (**9916-101203**)  
4 buttons: Pump 1/Light/Up/Down  
or  
Includes: in.k200-2OP keypad (**0607-008001**), overlay (**9916-101030**)  
4 buttons: Pump 1/Pump 2/Light/Up,Down  
Dimensions: 12 x 5.1 cm (4-3/4" x 2")  
Cord length: 3 m (10')  
Compatible with: in.xe & Y Series systems



Code **0607-005019**

**IN.K120-3OP AND OVERLAY**

Includes: in.k120 auxiliary keypad and overlay  
4 buttons: Pump 1/Pump 2/Pump 3/Light  
Dimensions: 14 x 5.4 cm (5-1/2" x 2-1/8")  
Cord length: 6 m (20')  
Compatible with: in.xe, in.xm, in.xm2 & Y Series systems

# Spa Keypads

## M-CLASS



Code **BDLTSC410K**

### TSC-4-10K-GE1 AND OVERLAY

Includes: TSC-4-10K keypad (0201-007044), overlay (9916-100761)  
 10 buttons: Pump 3/Pump 1/Pump 2/Blower/Light/Clock/Economy/Filter/Up/Down  
 Dimensions: 17.8 x 8.25 cm (7" x 3-1/4")  
 Cord length: 3 m (10')

Compatible with: M-CLASS systems



Code **BDLTSC4GE1**

### TSC-4-GE1 AND OVERLAY

Includes: TSC-4 keypad (0200-007119), overlay (9916-100094)  
 8 buttons: Up/Pump 1/Pump 2/Prog/Down/Blower/Light/Mode  
 Dimensions: 17.8 x 8.25 cm (7" x 3-1/4")  
 Cord length: 3 m (10')

Compatible with: M-CLASS systems



Code **BDLTSC810K**

### TSC-8-10K-GE1 AND OVERLAY

Includes: TSC-8-10K keypad (0201-007153), overlay (9916-100723)  
 10 buttons: Power/Pump 1/Pump 2/Light/Up/Economy/Pump 3/Blower/Filter/Down  
 Dimensions: 17.8 x 8.25 cm (7" x 3-1/4")  
 Cord length: 3 m (10')

Compatible with: M-CLASS systems



Code **BDLTSC8GE1**

### TSC-8-GE1 AND OVERLAY

Includes: TSC-8 keypad (0200-007113), overlay (9916-100130)  
 8 buttons: Pump 1/Pump 2/Blower/Light/Power/Filter/Up/Down  
 Dimensions: 17.8 x 8.25 cm (7" x 3-1/4")  
 Cord length: 3 m (10')

Compatible with: M-CLASS systems



Code **BDLTSC3GE1**

### TSC-3-GE1 AND OVERLAY

Includes: TSC-3 keypad (0200-007047), overlay (9916-100261)  
 4 buttons: Pump 1/Pump 2/Blower/Light  
 Dimensions: 11.4 x 5.1 cm (4-1/2" x 2")  
 Cord length: 3 m (10')

Compatible with: M-CLASS systems



Code **BDLTSC35GE1**

### TSC-35-GE1 AND OVERLAY

Includes: TSC-35 keypad (0202-007143), overlay (9916-100381)  
6 buttons: Pump 1/Pump 2/Blower/Light/Up/Down  
Dimensions: 17.8 x 8.25 cm (7" x 3-1/4")  
Cord length: 3 m (10')  
Compatible with: S-CLASS systems



Code **BDLTSC19PPD**

### TSC-19 AND OVERLAY KIT GE1-GE2

Includes: TSC-19 keypad (0202-007140), 1 pump overlay (9916-100218),  
2 pump overlay (9916-100219)  
4 buttons: Pump 1/Light/Up/Down or Pump 1/Pump 2/Light/Up,Down  
Dimensions: 17.8 x 8.25 cm (7" x 3-1/4")  
Cord length: 3 m (10')  
Compatible with: S-CLASS and U-CLASS systems



Code **BDLTSC18PPD**

### TSC-18 AND OVERLAY KIT GE1-GE2

Includes: TSC-18 keypad (0202-007134), 1 pump overlay (9916-100239),  
2 pump overlay (9916-100240)  
4 buttons: Pump 1/Light/Up/Down or Pump 1/Pump 2/Light/Up,Down  
Dimensions: 12.7 x 6.47 cm (5" x 2.55")  
Cord length: 3 m (10')  
Compatible with: S-CLASS and U-CLASS systems

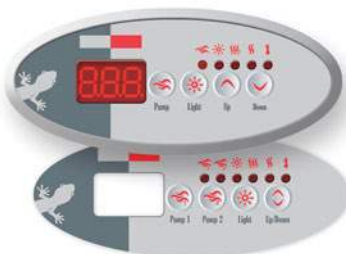

Code **BDLTSC9PPD**

### TSC-9 AND OVERLAY KIT GE1-GE2

Includes: TSC-9 keypad (0202-007154), 1 pump overlay (9916-100131),  
2 pumps overlay (9916-100186)  
4 buttons: Pump 1/Light/Up/Down or Pump 1/Pump 2/Light/Up,Down  
Dimensions: 11.4 x 5 cm (4-1/2" x 2")  
Cord length: 3 m (10')  
Compatible with: S-CLASS and U-CLASS systems

# Wi-Fi Spa Module

## in.touch



**in.touch**  
you're always in touch with your relaxation

- Control spa functions from your iDevice
- Intuitive layout
- Water care settings to save energy
- Preset experiences for ultimate relaxation
- Additional ports allow you to control up to 4 pumps individually with the in.k110

Compatible spa controllers:  
in.xm2, in.xe and Y Series with compatible software revision

Compatible devices:  
iPod touch (3rd generation and later)  
iPhone (3GS and later), iPad  
Requires iOS 5.0 and higher  
Android 2.2 and higher, compatible with Google Play

Router compatibility:  
Should not filter broadcast messages  
Should not use WEP encryption

\* iPad and iPhone not included.



Code	Description
------	-------------



0608-521012

### IN.TOUCH: Wi-Fi INTERFACE MODULE

Control your hot tub from your iDevice: iPad, iPhone, iPod.  
The module connects to your home Wi-Fi network to provide remote control of your spa.  
Apps:  
in.touch world (internet connection required)  
in.touch home (remote control from home Wi-Fi network only)  
Compatible with: in.xm2, in.xe and Y Series (software 85 rev 4.00 and up)



BDLK110

### IN.K110 AND OVERLAY

Includes: in.k110 keypad (0607-007010), overlay (9916-100480)  
1 button: control pump from each seat  
Dimensions: 3.8 cm (1-1/2") diameter  
Cord length: 6 m (20')  
Compatible with: in.touch Wi-Fi module





**in.link**  
ingenious output and input plugs and connectors

- IPX5 waterproof rated
- Color coded for easy connection
- Keyed connector to avoid miswiring
- 3 different formats available:
  - High-voltage, high-current (HC)
  - High-voltage, low-current (LC)
  - Low-voltage (LV)

**in.link exploded view**

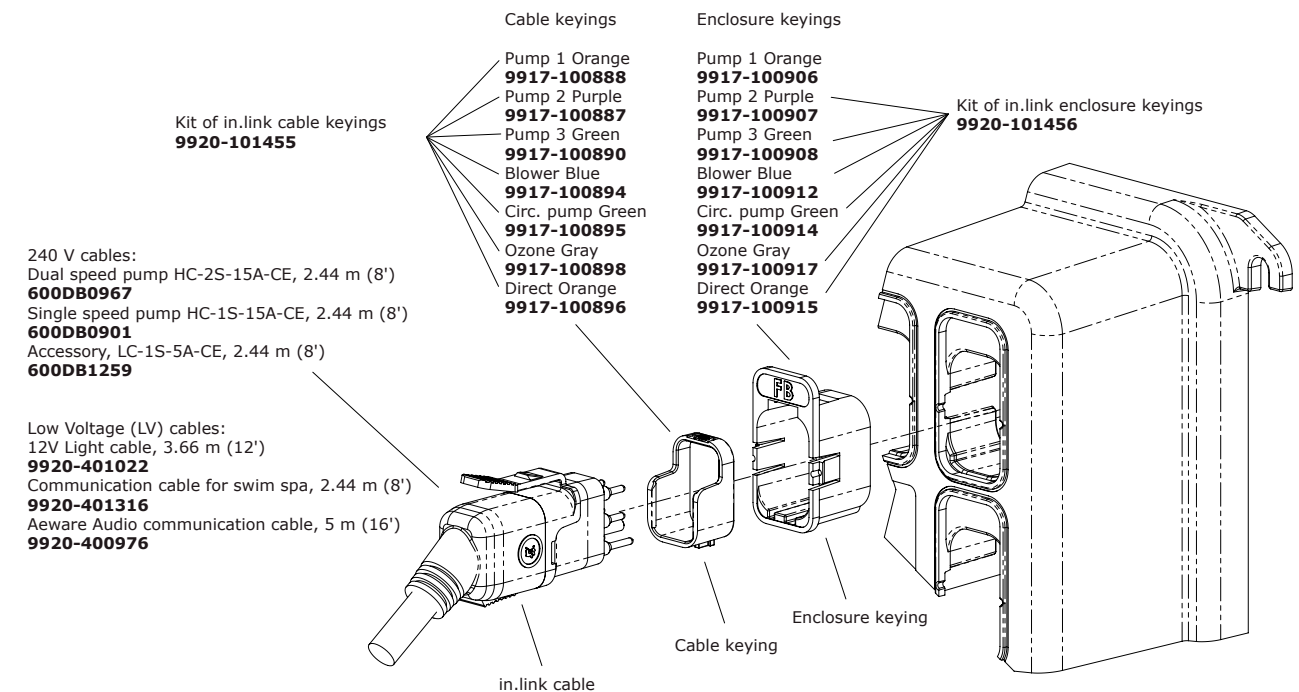

**AMP cables & adaptors**

	<b>Code</b>	<b>Description</b>
	95100517	CABLE: AMP-4P TO QC, SINGLE SPEED 14/3 1.2 m (4')
	95100519	CABLE: AMP-4P TO QC, DUAL SPEED 14/4 1.2 m (4')
	9920-401346	CABLE 1 SPD, AMP TO QUICK CONNECT, 14AWG, LENGTH 20 cm (8'')
	9920-401369	CABLE SPLITTER PP-1 AMP MALE TO 2 FEMALE, LENGTH 15 cm (6'')

## Spa Sanitizers

in.clear



W x H x D: 10.88" x 6.05" x 4.68"  
Weight: 2.3 kg (5 lb)



in.clear  
clean water done right



### Specifications

- User-friendly topside control panel
- Input rating: 240 V not switched
- in.clear flow rate:
  - A minimum of 3 GPM
  - A maximum of 40 GPM



### Features

- One of the most efficient water sanitization systems in the industry
- Programmable settings
- 2 operating modes: maintenance and boost
- Low maintenance and easy to handle
- Eliminates the need to add extra sanitizing chemicals
- Does not produce offensive odors

## in.clear solutions:

Code	Description
 0605-3000001	<b>IN.CLEAR, QUICK CONNECT CABLE, KEYPAD</b> Cord length: 2.44 m (8') Cord type: quick connect
 0605-3000002	<b>IN.TOUCH: Wi-Fi INTERFACE MODULE</b> Cord length: 2.44 m (8') Cord type: in.link-LC 240 V

## Chemical products:

Code	Description
 0699-300009	<b>2.2 KG (4.85 LB) BROMICHARGE BOTTLE (EUROMARKET)</b> Content: bromine salt Weight: 4.85 lb/2.2kg Works with: in.clear systems
 0699-300008	<b>BROMINE TEST KIT</b> Content: Bromine testing solution



**in.clear exploded view**

Complete in.clear bromine generator with topside  
**0605-300001** (Quick connect cord)  
**0605-300002** (in.link cord)

in.clear topside (3 m or 10' cord)  
with overlay & mounting bracket  
**0607-008010**

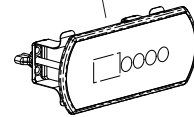
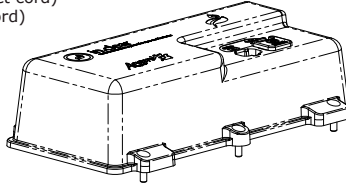

Replacement cell for in.clear  
**9920-101451**

Pressure switch  
**510AD0167** (2 PSI)

Bundle reducer 3/4" to 2"  
**0699-300007** (Bag of 2)

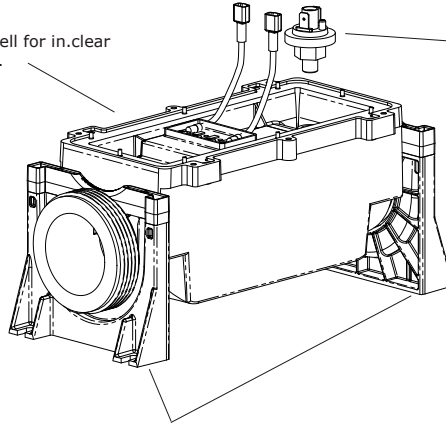

Compression fittings 2"  
**52272000** (Bag of 2)

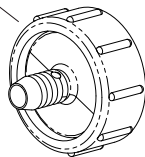

Mounting bracket  
**9920-101464**

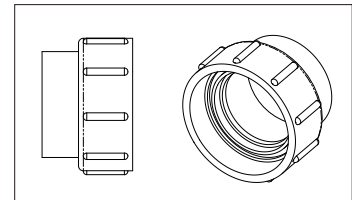

# Pump it greener

Outperforms its peers with less energy



## Circ-Master™

Circ-Master pumps provide whisper-quiet circulation of your spa water with less energy consumption.

You'll notice a significant reduction of noise compared to a standard 2-speed filtration pump, and receive smooth and consistent water flow of about 95 L/min, all while reducing your electrical bill!

Circ-Master is the smart choice to move water economically.



# Aqua-flo Pumps for Spas

## Flo-Master XP2e



**Flo-Master XP2e**  
greater flow-rates with overall energy efficiency

- Booster jet pumps
- Ideal for high-flow requirements
- Dual-speed and single speed available
- Flow rate up to 800 L/min
- 80-90 frame motors
- 2" intake and discharge
- 230 V, 50 Hz, TUV & IPX5 rated

### Performance Curve FM-XP2e

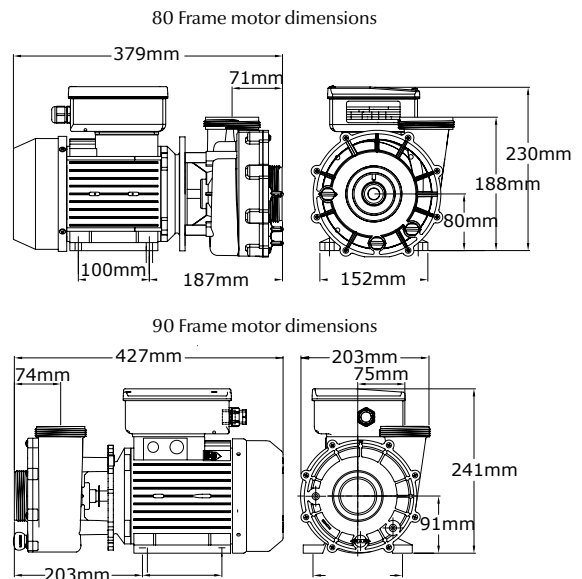
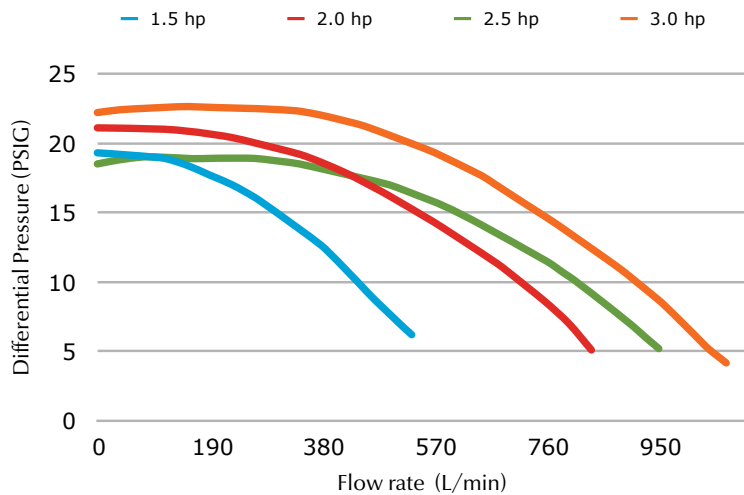

### Flo-Master XP2e Series, 230 V, 50Hz

Dual-speed, 2" intake & discharge

Part No.	Speed	hp	Frame	A (High)	A (Low)	Hi-Flow L/min
05320024-8040	2	1.5	80	6,7	1,6	300
05240006-8040	1	2.0	80	9.0		550
05340014-8040	2	2.0	80	9.0	1,8	550
05251010-8040	1	2.5	80	10,3		625
05351009-6040	2	2.5	90	10,3	1,8	625
05251010-8040	1	3.0	90	12,8		740

Every pump comes with 2 compression fittings & without cord.



### Flo-Master XP2e exploded view

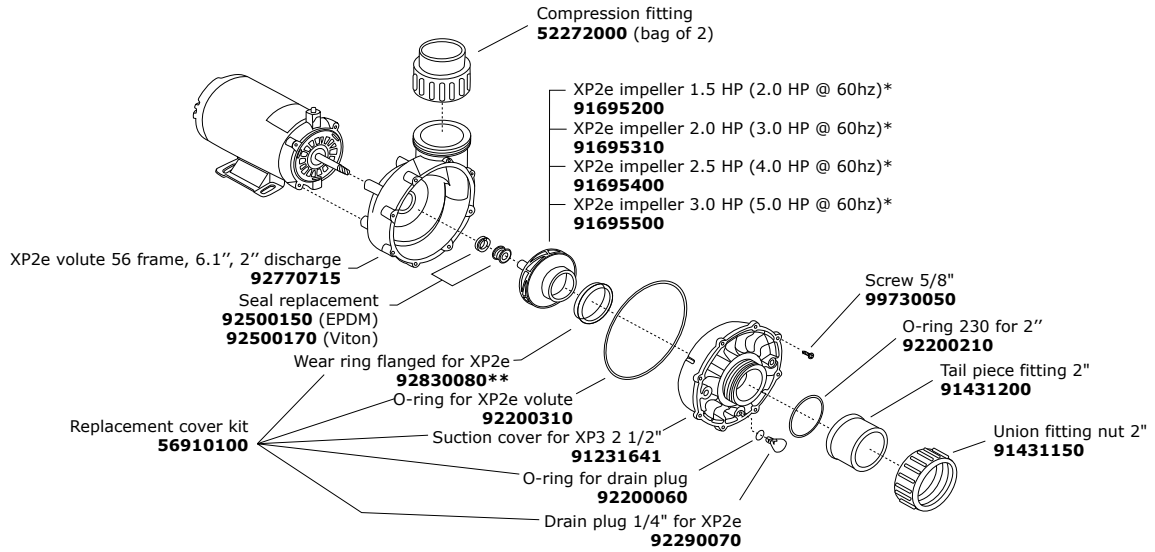

\* Impeller's Horse Power rating will show the 60Hz rating on the package.  
 \*\* 2.0 HP use wear ring **92830081**

### Flo-Master XP2e Wet Ends 56FR, 2" intake & 2" side discharge, 6.1" Euro legs



Part No.	HP @ 50hz*
91041921-000	1.5
91041624-000	2.0
91041941-000	2.5
91041951-000	3.0

\* Wetend's Horse Power rating will show the 60Hz rating on the package.



# Aqua-flo Pumps for Spas

## Circ-Master HP & CP



Circ-Master HP & CP  
24-hour recirculation pumps



- Ideal for 24/7 circ pump applications
- Single speed
- Flow rate up to 120 L/min
- 1 1/2" intake and discharge
- Wet end available in center or side discharger configuration
- Best efficiency of the industry: more than 100 L/min @ 135 W

### Dimension and Performance Curves Circ-Master

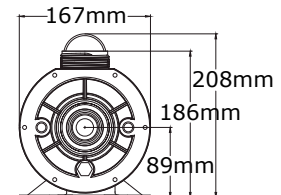
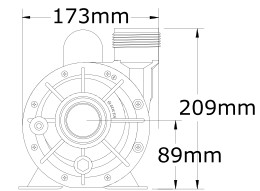
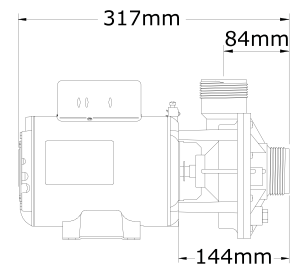
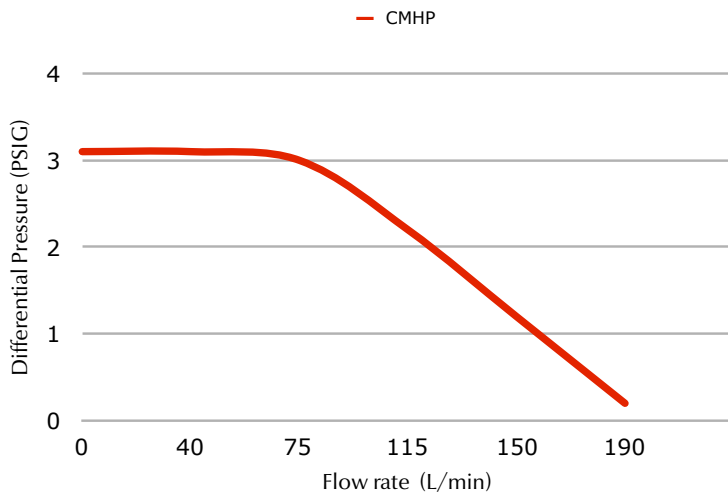

### Circ-Master HP and CP Series, 230 V, 50Hz

Dual-speed, 1.5" intake & discharge

Part No.	Discharge type	hp	Frame	A (High)	A (Low)	Hi-Flow L/min
02420009-2010	Side (CMHP)	1/15	48	0,6		120
02920000-2020	Center (CMCP)	1/15	48	0,6		115

Every pump comes with 2 compression fittings & without cord.



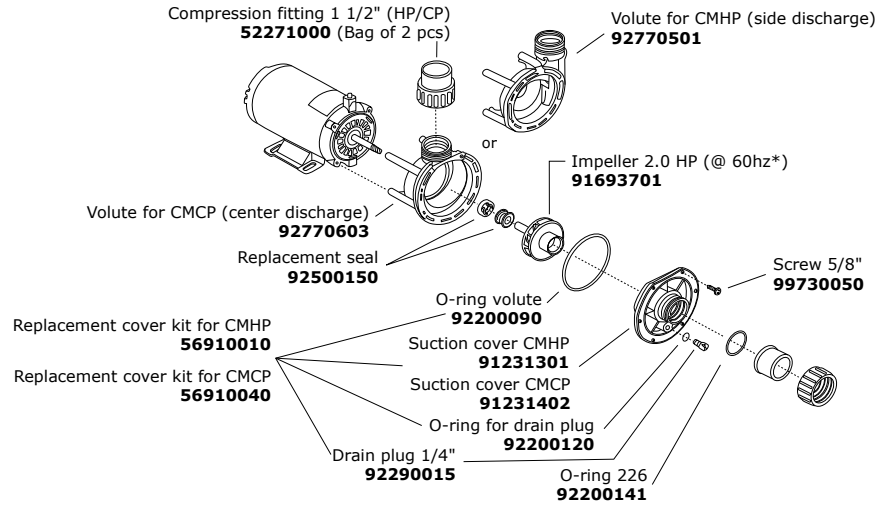

**Circ-Master HP & CP exploded view**



\* Impeller's Horse Power rating will show the 60Hz rating on the package.

**Circ-Master Wet Ends 48FR, 1 1/2" intake & 1 1/2" discharge**

	Part No.	OP:HP*	Discharge
	91040840-000	1/15	Center
	91040730-000	1/15	Side



\* iPod not included.



**in.stream**  
wireless music streamed into your yard

- Bluetooth wireless streaming and auxiliary input
- Stand-alone audio system
- Bluetooth transceiver and an amplifier to host your speakers
- Compatible with in.k175
- Easy to install after production
- Runs on 12 V DC

---

**Code**                      **Description**



**0704-100002                      IN.STREAM AUDIO SYSTEM**

Audio sources: Bluetooth streaming, Auxiliary input  
Voltage: 12 V DC  
Waterproof: yes  
Compatible with: in.k175 (0707-005012)



**0707-005012                      IN.K175-BK-SPA-AE3 FOR IN.STREAM**

Auxiliary audio keypad in.k175, black, for in.stream audio system.  
Waterproof mini-DIN extension cable 6 m, with Aeware overlay.  
7 buttons: Power/Bluetooth/AUX/Up/Track down/Track up/Down  
Dimensions: 9 cm x 5.5 cm (3.58" x 2.15")  
Cord length: 6 m (20')  
Compatible with: in.stream audio system



**BDLSTRMk175                      BUNDLE: IN.STREAM, IN.K175 KEYPAD**

The in.stream is a Bluetooth wireless receiver with 4 x 40W amplifier.  
Kit includes:  
in.stream audio system (0704-100002)  
in.k175 with overlay (0707-005012)

\*iPod not included



**9920-400976                      AEWARE AUDIO COMMUNICATION CABLE**

Cable length: 5 m (16')  
Compatible with: in.stream & in.tune audio systems and in.xm, in.xm2  
and Y Series controls with in.k500 or in.k800 topsides.

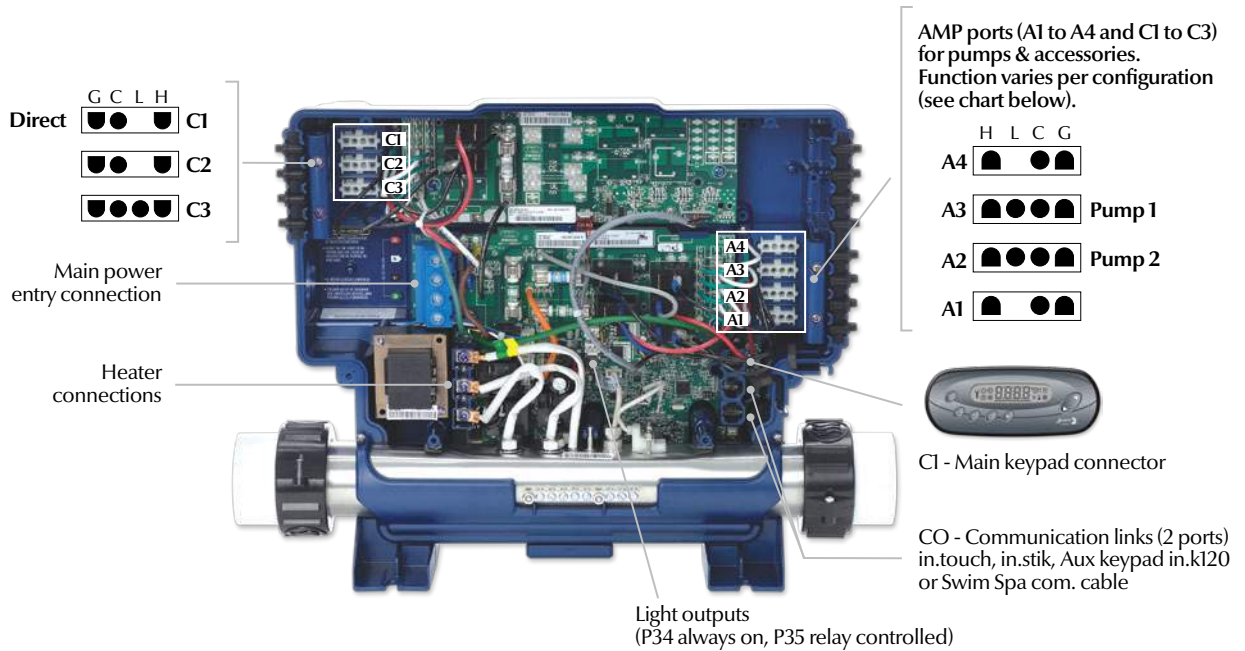

**Preloaded Spa configurations, ID # 0611-221009, Software # 231 rev 1.0**

Information between ( ) indicates which AMP connector to use. See above drawing for connector's position.

Config. #	Pump 1	Pump 2	Pump 3	Pump 4	Pump 5	Blower	Circ. Pump (CP)	Ozone <sup>1</sup>	Filter Cycle (Daily)	Heater Pump
1	1sp (A3)	1sp (A2)	1sp (A1)				(C2)	(A4)	2 x 6 hours with CP	CP
2	1sp (A3)	1sp (A2)	1sp (A1)			(C3)	(C2)	(A4)	2 x 6 hours with CP	CP
3	1sp (A3)	1sp (A2)	1sp (A1)	1sp (C3)			(C2)	(A4)	2 x 6 hours with CP	CP
4	1sp (A3)	1sp (A2)	1sp (A1)	1sp (C3)		(A4)	(C2)	(K2-P tab) <sup>2</sup>	2 x 6 hours with CP	CP
5	1sp (A3)	1sp (A2)	1sp (A1)	1sp (C3)	1sp (A4)		(C2)	(K2-P tab) <sup>2</sup>	2 x 6 hours with CP	CP
6	1sp (A3)	1sp (A2)	1sp (A1)	1sp (C3)	1sp (A4)	(C2)	(K2-P tab) <sup>2</sup>		2 x 6 hours with CP	CP
7	2sp (A3)	1sp (A2)	1sp (A1)					(A4)	2 x 2 hours with PIL	Pump 1
8	2sp (A3)	1sp (A2)	1sp (A1)					(A4)	2 x 2 hours with PIL	Pump 1
9	2sp (A3)	1sp (A2)	1sp (A1)				(C2)	(A4)	2 x 6 hours with CP	CP
10	2sp (A3)	1sp (A2)	1sp (A1)				(C2)	(A4)	2 x 6 hours with CP	CP
11	2sp (A3)	1sp (A2)	1sp (A1)	1sp (C3)				(A4)	2 x 2 hours with PIL	Pump 1
12	2sp (A3)	1sp (A2)	1sp (A1)	1sp (C3)				(C2)	2 x 2 hours with PIL	Pump 1
13	2sp (A3)	1sp (A2)	1sp (A1)	1sp (C3)			(C2)	(A4)	2 x 6 hours with CP	CP
14	2sp (A3)	1sp (A2)	1sp (A1)	1sp (C3)			(C2)		2 x 6 hours with CP	CP
15	2sp (A3)	1sp (A2)	1sp (A1)	1sp (C3)	1sp (A4)				2 x 2 hours with PIL	Pump 1
16	2sp (A3)	1sp (A2)	1sp (A1)	1sp (C3)	1sp (A4)			(C2)	2 x 2 hours with PIL	Pump 1
17	2sp (A3)	2sp (A2)						(C3)	2 x 2 hours with PIL	Pump 1
18	2sp (A3)	2sp (A2)				(A1)		(C3)	2 x 2 hours with PIL	Pump 1
19	2sp (A3)	2sp (A2)					(C2)	(C3)	2 x 6 hours with CP	CP
20	2sp (A3)	2sp (A2)				(A1)	(C2)	(C3)	2 x 6 hours with CP	CP
21	2sp (A3)	2sp (A2)						(C3)	2 x 2 hours with PIL	Pump 1
22	2sp (A3)	2sp (A2)	1sp (A1)					(C3)	2 x 2 hours with PIL	Pump 1
23	2sp (A3)	2sp (A2)					(C2)	(C3)	2 x 6 hours with CP	CP
24	2sp (A3)	2sp (A2)	1sp (A1)				(C2)	(C3)	2 x 6 hours with CP	CP
25	2sp (A3)	2sp (A2)	1sp (A1)			(C3)		(C2)	2 x 2 hours with PIL	Pump 1
26	2sp (A3)	2sp (A2)	1sp (A1)			(C3)	(C2)		2 x 6 hours with CP	CP
27	2sp (A3)	2sp (A2)	2sp (C3)					(A1)	2 x 2 hours with PIL	Pump 1
28	2sp (A3)	2sp (A2)	2sp (C3)			(A1)			2 x 2 hours with PIL	Pump 1
29	2sp (A3)	2sp (A2)	2sp (C3)			(A1)	(C1) <sup>3</sup>		2 purges, CP Always on	CP
30	2sp (A3)	1sp (A2)	1sp (C3)			(A4)		(C2)	2 x 2 hours with PIL	Pump 1

**Note 1:** When the Ozonator is not controlled by a relay, it can be tied to Pump 1 Low speed or Circ. Pump using AMP cable 9920-401369.

**Note 2:** This accessory does not have its own AMP connector. Wire an extra AMP connector 9920-401346 (not supplied) as follows: Black wire to P43 tab on the board, Green to any Ground tabs and white to any Neutral tabs.

**Note 3:** Circulation pump is connected to a Direct fused outlet. Pump will always be on any create water overheat if oversized pump is used.

# Low Level Configuration

in.ye

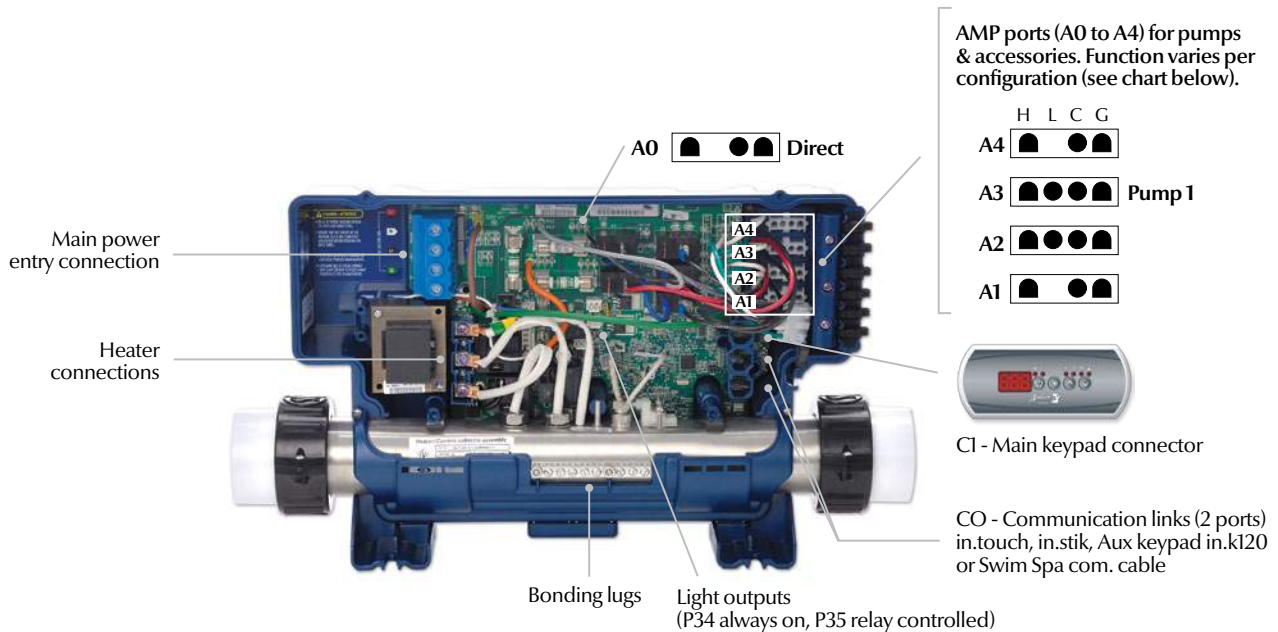

## Preloaded spa configurations, ID # 0610-221017, Software # 232 rev 1.0

Information between ( ) indicates which AMP connector to use. See above drawing for connector's position.

Config. #	Pump 1	Pump 2	Pump 3	Pump 4	Pump 5	Blower	Circ. Pump (CP)	Ozone <sup>1</sup>	Filter Cycle (Daily)	Heater Pump
1	1 sp (A3)						(A1)	(A4)	2 x 6 hours with CP	CP
2	1 sp (A3)	1 sp (A2)					(A1)	(A4)	2 x 6 hours with CP	CP
3	1 sp (A3)					(A4)	(A1)	(A2)	2 x 6 hours with CP	CP
4	1 sp (A3)	1 sp (A2)				(A4)	(A1)	(P43 Tab) <sup>2</sup>	2 x 6 hours with CP	CP
5	1 sp (A3)	1 sp (A2)	1 sp (A1)				(A4)	(P43 Tab) <sup>2</sup>	2 x 6 hours with CP	CP
6	1 sp (A3)	1 sp (A2)	1 sp (A1)			(A4)	(A3) <sup>2</sup>		2 x 6 hours with CP	CP
7	2 sp (A3)						(A1)	(A1)	2 x 2 hours with PIL	Pump 1
8	2 sp (A3)						(A1)	(A4)	2 x 6 hours with CP	CP
9	2 sp (A3)	1 sp (A2)					(A1)	(A1)	2 x 2 hours with PIL	Pump 1
10	2 sp (A3)	1 sp (A2)					(A1)	(A4)	2 x 6 hours with CP	CP
11	2 sp (A3)					(A4)	(A1)	(A1)	2 x 2 hours with PIL	Pump 1
12	2 sp (A3)					(A4)	(A1)	(A2)	2 x 6 hours with CP	CP
13	2 sp (A3)	1 sp (A2)				(A4)	(A1)	(A1)	2 x 2 hours with PIL	Pump 1
14	2 sp (A3)	1 sp (A2)				(A4)	(A1)		2 x 6 hours with CP	CP
15	2 sp (A3)	1 sp (A2)	1 sp (A1)					(A4)	2 x 2 hours with PIL	Pump 1
16	2 sp (A3)	1 sp (A2)	1 sp (A1)				(A4)		2 x 6 hours with CP	CP
17	2 sp (A3)	2 sp (A2)						(A1)	2 x 2 hours with PIL	Pump 1
18	2 sp (A3)	2 sp (A2)					(A1)		2 x 6 hours with CP	CP
19	2 sp (A3)	2 sp (A2)				(A1)			2 x 2 hours with PIL	Pump 1
20	2 sp (A3)	2 sp (A2)	1 sp (A1)						2 x 2 hours with PIL	Pump 1
21	1 sp (A3)	1 sp (A2)	1 sp (A4)	1 sp (P43 Tab) <sup>2</sup>			(A1)		2 x 6 hours with CP	CP
22 <sup>3</sup>	1 sp (A3)	1 sp (A2)	1 sp (A1)	1 sp (A4)			(P43 Tab) <sup>2</sup>		2 x 6 hours with CP	CP
<b>Swim Spa</b>										
51 (Master)	1 sp (A3)	1 sp (A2)				(A4)	(A1)		2 x 6 hours with CP	CP
51 (Slave)			1 sp (A3)	1 sp (A2)				(A1)		
52 (Master)	2 sp (A3)	1 sp (A2)				(A4)			2 x 2 hours with PIL	Pump 1
52 (Slave)			1 sp (A3)	1 sp (A2)				(A1)		
53 (Master)	2 sp (A3)	1 sp (A2)	1 sp (A1)				(A4)		2 x 6 hours with CP	CP
53 (Slave)				1 sp (A3)	1 sp (A2)	(A4)		(A1)		
54 (Master)	2 sp (A3)	1 sp (A2)	1 sp (A1)						2 x 2 hours with PIL	Pump 1
54 (Slave)				1 sp (A3)	1 sp (A2)	(A4)		(A1)		

**Note 1:** When the Ozonator is not controlled by a relay, it can be tied to Pump 1 Low speed or Circ. Pump using cable AMP 9920-401369.

**Note 2:** This accessory does not have its own AMP connector. Rewire A0 if not used or order extra AMP connector 9920-401346 (Black wire to P43 tab on the board, Green to any Ground tabs and white to any Neutral tabs).

**Note 3:** Configurations 21 and 22 have different power management. 21 will allow all pump to be turned on at same time and 22 will turn heater Off when pump 3 is started.





**Preloaded spa configurations, ID # 0601-221105, Software # 186 rev 2.0**

Information between ( ) indicates which in.link-HV port to use. See above drawing for port's position.

Config. #	Pump 1	Pump 2	Pump 3	Pump 4	Pump 5	Blower	Ozone	Circ. Pump	Filter Cycle (Daily)	Heater Pump
1	1 sp (Out 3)						(Out 4)	(Out 6)	2 x 2 hours with CP	CP
2	1 sp (Out 3)					(Out 5)	(Out 4)	(Out 6)	2 x 2 hours with CP	CP
3	1 sp (Out 3)	1 sp (Out 2)					(Out 4)	(Out 6)	2 x 2 hours with CP	CP
4	1 sp (Out 3)	1 sp (Out 2)				(Out 5)	(Out 4)	(Out 6)	2 x 2 hours with CP	CP
5	1 sp (Out 3)	1 sp (Out 2)	3 sp (Out 1)				(Out 4)	(Out 6)	2 x 2 hours with CP	CP
6	1 sp (Out 3)	1 sp (Out 2)	3 sp (Out 1)			(Out 5)	(Out 4)	(Out 6)	2 x 2 hours with CP	CP
7	1 sp (Out 3)	1 sp (Out 2)	3 sp (Out 1)	1 sp (Out 3)*			(Out 4)	(Out 6)	2 x 2 hours with CP	CP
8	1 sp (Out 3)	1 sp (Out 2)	3 sp (Out 1)	1 sp (Out 3)*		(Out 5)	(Out 4)	(Out 6)	2 x 2 hours with CP	CP
9	1 sp (Out 3)	1 sp (Out 2)	3 sp (Out 1)	1 sp (Out 3)*	1 sp (Out 2)*		(Out 4)	(Out 6)	2 x 2 hours with CP	CP
10	1 sp (Out 3)	1 sp (Out 2)	3 sp (Out 1)	1 sp (Out 3)*	1 sp (Out 2)*	(Out 5)	(Out 4)	(Out 6)	2 x 2 hours with CP	CP
11	2 sp (Out 3)						(Out 4)		2 x 2 hours with PIL	PI
12	2 sp (Out 3)						(Out 4)	(Out 6)	2 x 2 hours with CP	CP
13	2 sp (Out 3)					(Out 5)	(Out 4)		2 x 2 hours with PIL	PI
14	2 sp (Out 3)					(Out 5)	(Out 4)	(Out 6)	2 x 2 hours with CP	CP
15	2 sp (Out 3)	1 sp (Out 2)					(Out 4)		2 x 2 hours with PIL	PI
16	2 sp (Out 3)	1 sp (Out 2)					(Out 4)	(Out 6)	2 x 2 hours with CP	CP
17	2 sp (Out 3)	1 sp (Out 2)				(Out 5)	(Out 4)		2 x 2 hours with PIL	PI
18	2 sp (Out 3)	1 sp (Out 2)				(Out 5)	(Out 4)	(Out 6)	2 x 2 hours with CP	CP
19	2 sp (Out 3)	1 sp (Out 2)	3 sp (Out 1)				(Out 4)		2 x 2 hours with PIL	PI
20	2 sp (Out 3)	1 sp (Out 2)	3 sp (Out 1)				(Out 4)	(Out 6)	2 x 2 hours with CP	CP
21	2 sp (Out 3)	1 sp (Out 2)	3 sp (Out 1)			(Out 5)	(Out 4)		2 x 2 hours with PIL	PI
22	2 sp (Out 3)	1 sp (Out 2)	3 sp (Out 1)			(Out 5)	(Out 4)	(Out 6)	2 x 2 hours with CP	CP
23	2 sp (Out 3)	2 sp (Out 2)	3 sp (Out 1)				(Out 4)		2 x 2 hours with PIL	PI
24	2 sp (Out 3)	2 sp (Out 2)	3 sp (Out 1)				(Out 4)	(Out 6)	2 x 2 hours with CP	CP
25	2 sp (Out 3)	2 sp (Out 2)	3 sp (Out 1)			(Out 5)	(Out 4)		2 x 2 hours with PIL	PI
26	2 sp (Out 3)	2 sp (Out 2)	3 sp (Out 1)			(Out 5)	(Out 4)	(Out 6)	2 x 2 hours with CP	CP

\* 2 Pumps connect to the same Output (Out) using in.split-HC

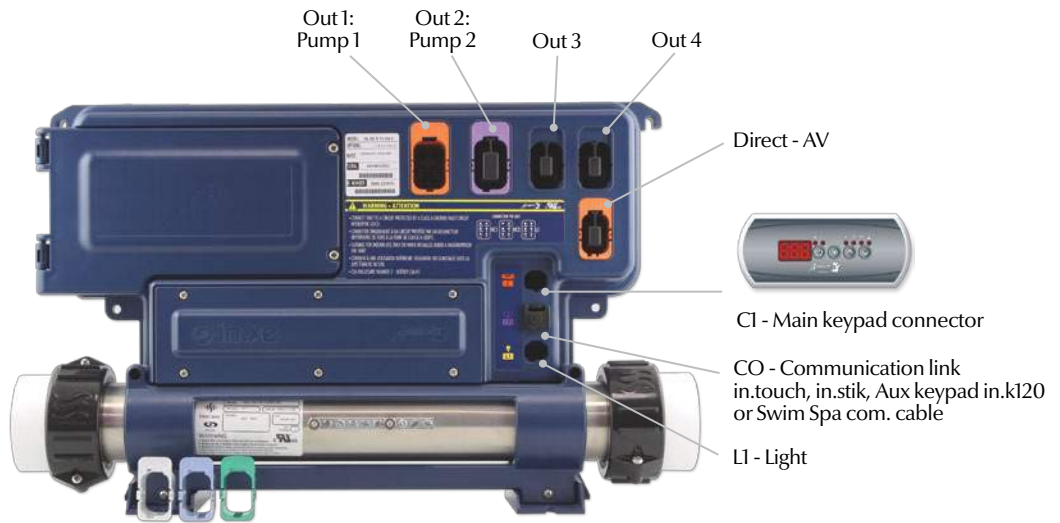

**Preloaded spa configurations, ID # 0602-221047, Software # 209 rev 1.0**

Information between ( ) indicates which in.link-HV port to use. See above drawing for port's position.

Config. #	Pump 1	Pump 2	Blower	Circ. Pump (CP)	Ozone	Filter Cycle (Daily)	Heater Pump
1	2 sp (Out 1)	1 sp (Out 2)	(Out 3)	24/7 (Out 4)		2 x 2 hours with PIL	Pump 1
2	2 sp (Out 1)	1 sp (Out 2)	(Out 3)	24/7 (Out 4)		2 x Purges	Circulation Pump
3	2 sp (Out 1)	1 sp (Out 2)	(Out 3)		(Out 4)	2 x 2 hours with PIL	Pump 1
4	2 sp (Out 1)	1 sp (Out 2)		(Out 3)	(Out 4)	2 x 2 hours with CP	Pump 1
5	2 sp (Out 1)	1 sp (Out 2)	(Out 3)	24/7 (Out 3)	(Out 4)	2 x 2 hours with PIL	Circulation Pump
6	2 sp (Out 1)	1 sp (Out 2)		(Out 3)	(Out 4)	2 x 2 hours with CP	Circulation Pump
7	2 sp (Out 1)	1 sp (Out 2)			(Out 4)	2 x 2 hours with PIL	Pump 1
8	2 sp (Out 1)		(Out 3)		(Out 4)	2 x 2 hours with PIL	Pump 1
9	2 sp (Out 1)				(Out 4)	2 x 2 hours with PIL	Pump 1
10	1 sp (Out 1)	1 sp (Out 2)	(Out 3)		(Out 4)	2 x 2 hours with PI	Pump 1
11	1 sp (Out 1)	1 sp (Out 2)		(Out 3)	(Out 4)	2 x 2 hours with CP	Pump 1
12	1 sp (Out 1)	1 sp (Out 2)		24/7 (Out 3)	(Out 4)	2 x purges	Circulation Pump
13	1 sp (Out 1)			24/7 (Out 3)	(Out 4)	2 x purges	Circulation Pump



## GECKO DEPOT

[www.geckodepot.com](http://www.geckodepot.com)

### Europe

Via Isonzo 21/E, 34070 Mossa GO Italy  
Tel: +39 0481 637363, Fax: +39 0481 637392  
[support\\_europe@geckodepot.com](mailto:support_europe@geckodepot.com)

### USA

7215 Bermuda Road, Las Vegas NV 89119 USA  
Tel: 1.800.784.3256, Fax: 1.866.759.0906  
[support\\_usa@geckodepot.com](mailto:support_usa@geckodepot.com)

### Canada

450 des Canetons, Quebec City QC G2E 5W6 Canada  
Tel: 1.800.784.3256, Fax: 1.866.759.0906  
[techsupport@geckodepot.com](mailto:techsupport@geckodepot.com)

Gecko Depot  
Member of Gecko Alliance

